

**BUILDING TOTALS:**

TOTAL CLEANING MAIN FLOOR: 15,849 sq.ft.

TOTAL CLEANING SECOND FLOOR: 10,330 sq.ft.

TOTAL CLEANING ALL FLOORS: 26,179 sq.ft.

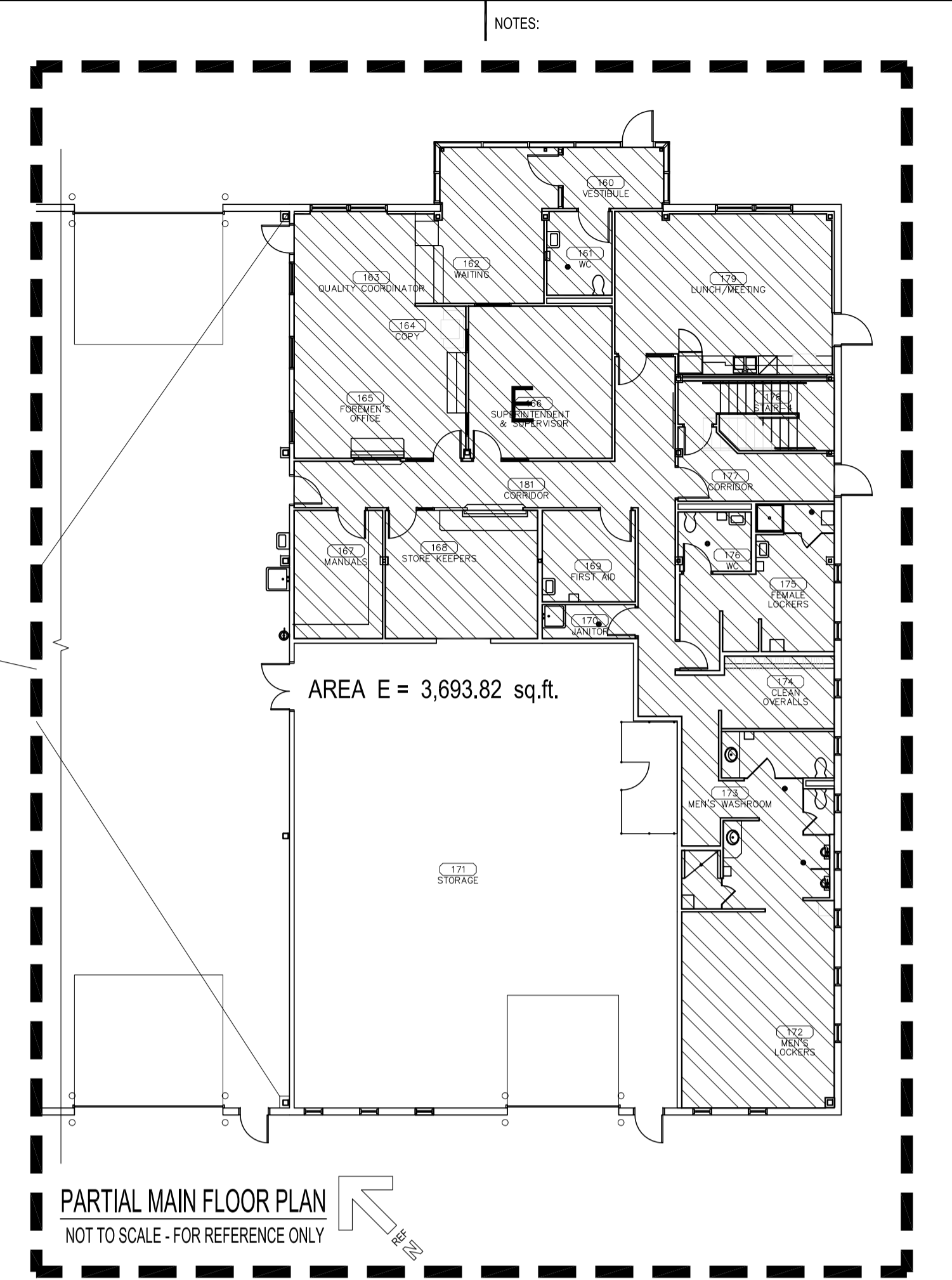

PARTIAL MAIN FLOOR PLAN  
NOT TO SCALE - FOR REFERENCE ONLY

AREA A = 81.46 sq.ft.

AREA B = 2,693.3 sq.ft.

AREA C = 7,899.46 sq.ft.

AREA D = 1,842.94 sq.ft.

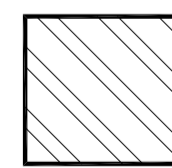

ALL YEAR: SUMMER AND WINTER: ONE SHIFT / DAY- YEAR ROUND

TOTAL AREA = 5,926 sq.ft.

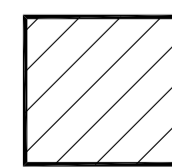

WINTER HOURS: TWICE / DAY: DAY & NIGHT SHIFT- 7 DAYS / WEEK

TOTAL AREA = 9,923 sq.ft.

No.	REVISION/DESCRIPTION	BY	DATE

DRAWN	TC	CHECKED	CAD	DESIGNED	CAD	APPROVED	CAD

THE CITY OF WINNIPEG  
PLANNING, PROPERTY AND  
DEVELOPMENT DEPARTMENT  
MUNICIPAL ACCOMMODATIONS DIVISION  
3-65 GARRY STREET, R3C 4K4

PROJECT  
CITY OF WINNIPEG  
EAST YARD COMPLEX  
MAIN AND SECOND FLOORS  
960 THOMAS AVE.

SHEET TITLE  
AREAS TO CLEAN: MAIN FLOOR

0960TM01

SCALE	PROJECT No:	SHEET No:
AS SHOWN	351-2018	A1